

Full HD 1080P Video Game Capture H.264 encoder

Operating Instructions

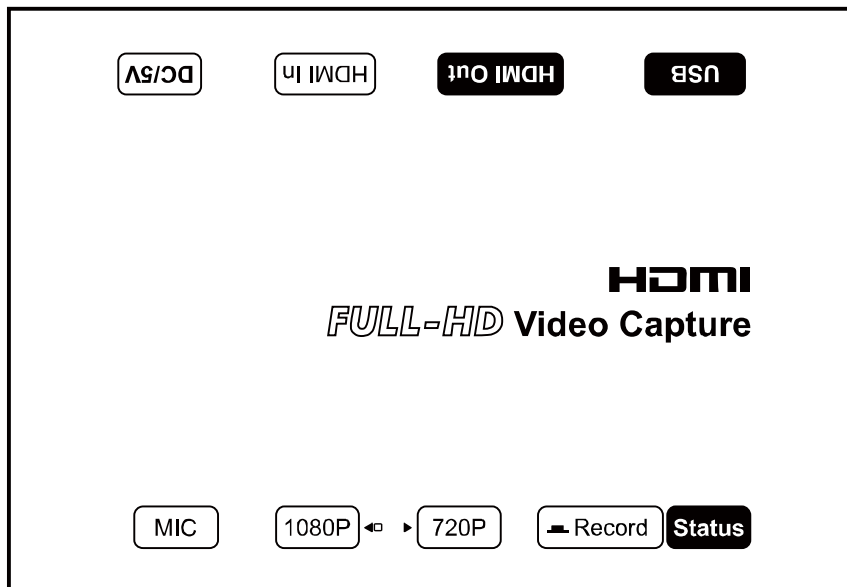

Dear Customer

Thank you for purchasing this product. For optimum performance and safety, please read these instructions carefully before connecting, operating or adjusting this product. Please keep this manual for future reference.

FEATURES

- Support HDMI signal source of PlayStation 4, Xbox One and Xbox 360 game play in brilliant 1080p@60HZ with advanced H.264 encoding.
- Recording with one-click, easy to use, no need any set up.
Just click "RECORD" button to record your game play and re-click to stop recording.
- Support NTFS/FAT32 format.
- Support USB 2.0 Host.
- Automatically split the video up to 2GB per file.
- Support record video format of MPEG-4 and audio format of RCA L/R 3.5mm microphone input.
- Support by pass mode or downscaling 1080P/1080i to 720P.

NOTICE

Our company reserve the right to make changes in the hardware, packaging and any accompanying documentation without prior written notice.

TABLE OF CONTENTS

Specifications
 Package Contents
 Panel Descriptions
 Connecting and Operating
 Maintenance
 Product Service
 Warranty

SPECIFICATIONS

Operating Temperature Range	-5 to +35°C(+23 to +95°F)
Operating Humidity Range	5 to 90%RH (No Condensation)
Output Video Format	MPEG-4
encoder	H.264
Input resolution	720x480(60HZ);720x576(50HZ);1280X720P(50HZ/60HZ) 1920X1080i(50HZ/60HZ); 1920X1080P(24HZ/25HZ/30HZ/50HZ/60HZ)
Capture resolution	720x480(60HZ);720x576(50HZ);1280X720P(50HZ/60HZ) 1920X1080i(50HZ/60HZ); 1920X1080P(24HZ/25HZ/30HZ)
Support Audio Format	LPCM
Bandwidth	2.25Gbps
USB	2.0
Power consumption	3watts(Maximum)
Dimension (L×W×H)	102.2x70.1x27.1mm
Net Weight	220g(Pcs)

PACKING CONTENTS

- 1) Game capture
- 2) 5V/1A x1 PCS
- 3) Operating Instructions

PANEL DESCRIPTIONS

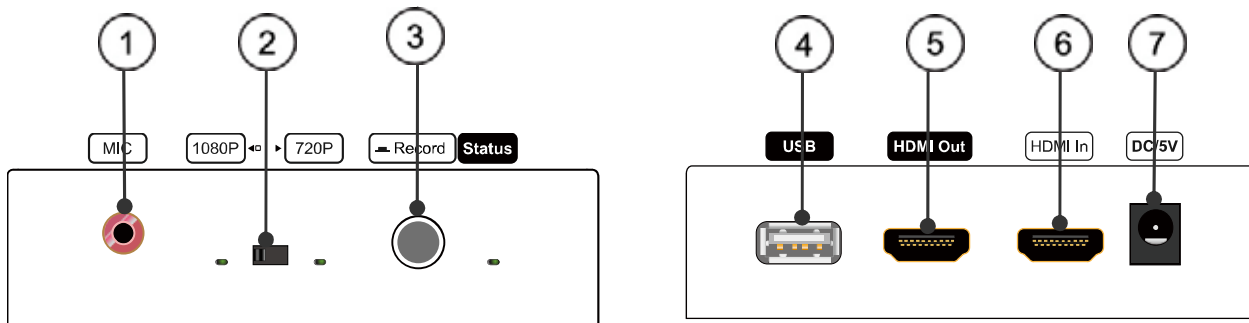

1) 3.5 microphone in

2) 1080P/720 Switch Button

- When the input resolution is 1080p, you can switch to 1080p by pass mode or downscale to 720P.

- When the input resolution is 1080P@60hz, the capture resolution will be 1080P@30hz.

- When the input resolution is 1080i@50hz, 1080i@60hz, you can switch to 1080P@24hz or downscale to 720p.

- When the input resolution is 720p or lower than 720p, please switch to "720P" position, it is by pass mode.

3) "RECORD" button (click "RECORD" button to record your game play and re-click to stop recording)

4) USB port

5) HDMI output

6) HDMI input

7) Power input

CONNECTING AND OPERATING

1) Connect the HDMI signal sources (Such as Industry HD Camera, PlayStation 4, Xbox 360 etc).

2) Connect the HDMI Output (Such as Computer, TV).

3) Connect the USB host (Such as HDD or USB flash).

4) Connect the microphone to the "Mic" hole.

5) Connect the DC 5V1A power supply.

6) Power on and click the "RECORD" button to start recording.

7) The LED status will flash when start recording.

8) Re-click the "RECORD" button to stop recording.

9) The LED status will stop flashing and keep lighting when finishing recording.



Note **Attention:**

1). It is suggested to use HDD for recording.

2). Do not pull out the HDD when recording.

3). Make sure the limited space for HDD is above 80M, otherwise it's unavailable for recording.

Typical Application

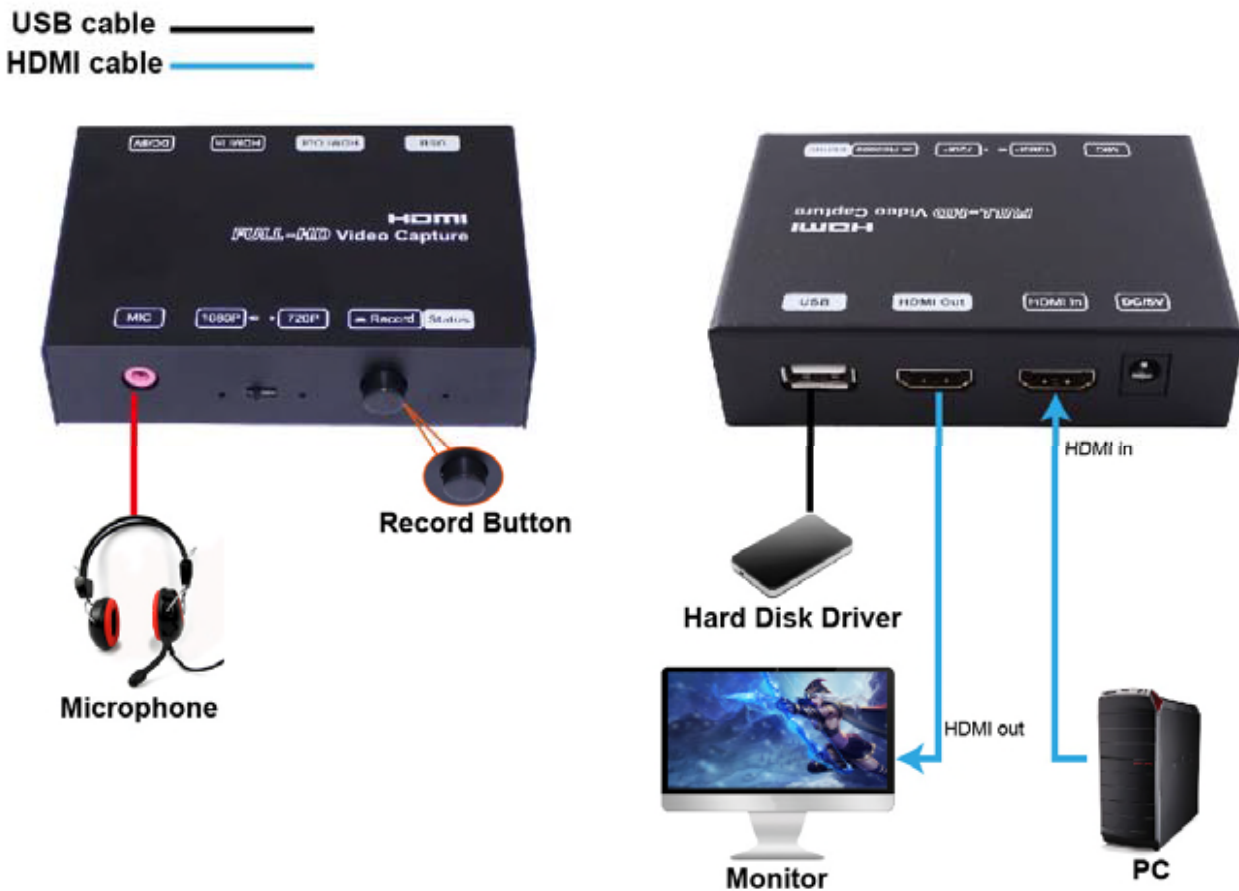

WARRANTY

If your product does not work properly because of a defect in materials or workmanship, our Company (referred to as "the warrantor") will, for the length of the period indicated as below, **(Parts(2)Year, Labor(90) Days)** which starts with the date of original purchase ("Limited Warranty period"), at its option either(a) repair your product with new or refurbished parts, or (b) replace it with a new of a refurbished product. The decision to repair or replace will be made by the warrantor. During the "Labor" Limited Warranty period there will be no charge for labor. During the "Parts" warranty period, there will be no charge for parts. You must mail-in your product during the warranty period. This Limited Warranty is extended only to the original purchaser and only covers product purchased as new. A purchase receipt or other proof of original purchase date is required for Limited Warranty service.

MAIL-IN SERVICE

When shipping the unit carefully pack and send it prepaid, adequately insured and preferably in the original carton. Include a letter detailing the complaint and provide a day time phone and/or email address where you can be reached.